

Tanzanite 24



4



2



1



2

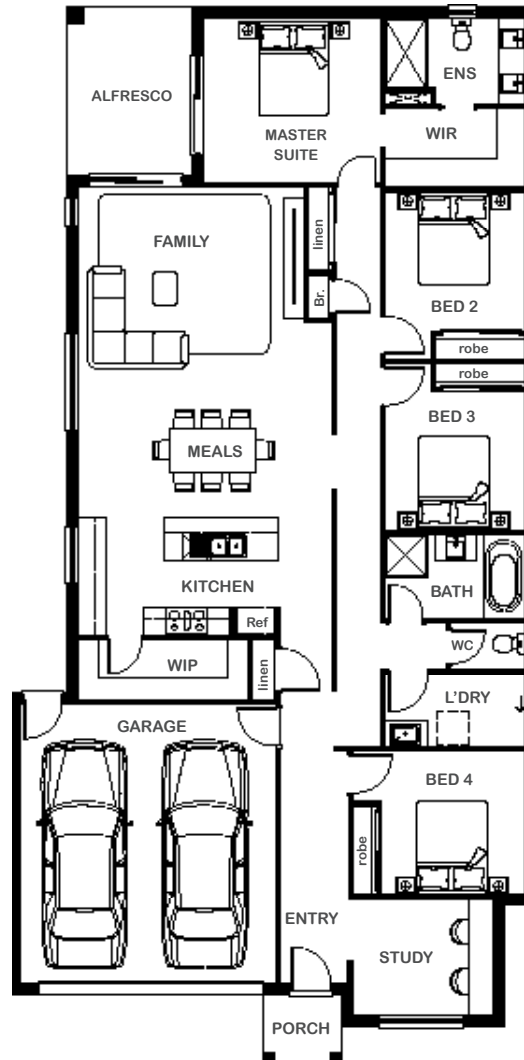

Overall Width x Length

11.3m x 22.7m

Total House Area

224.91m²

Suitable For Lot

12.5m x 30.0m

Room Sizes

Master Suite	3.78m x 3.52m
Bedroom 2	3.00m x 3.00m
Bedroom 3	3.00m x 3.00m
Bedroom 4	3.09m x 3.10m
Family	4.43m x 4.13m
Study	3.00m x 2.50m
Meals	5.44m x 3.00m

Key Features

- Four-bedroom single storey home total
- Master suite with adjoining ensuite and walk-in robe
- One large family area and large study space upon entrance
- Double garage
- Open plan living, dining and kitchen
- Large walk-in pantry
- Multiple facade options

Specifications

House	175.49m ²	18.88sq
Garage	37.13m ²	4.00sq
Alfresco	9.75m ²	1.05sq
Porch	2.54m ²	0.27sq
Total	224.91m²	24.20sq



1800 XIRCON (1800 947 266)
xirconhomes.com.au

All images and illustrations featured on Xircon Homes' website and in any advertisements are solely for illustrative purposes and are intended to be used as a guide only. Photographs and floor plans may depict specifications not currently provided by Xircon Homes and not included in the price of your home. Façades may not be accurate. This is due to house type, size, house design and house width. Subject to estate and council guidelines. For detailed home pricing and façade information, please speak to a New Home Advisor.